

8IGHT 2.0/8IGHT-T 2.0 Starter Box LOSA99059

Installing the Battery

You have two battery options to power your 8IGHT™ 2.0 starter box. You can use (2) 7.2 NiMH battery packs (not included) or you can use one Losi® 14.8V 4S LiPo Starter Box Battery (not included). Preassembled wiring harnesses and mounting fixtures for both of these power source options are included. Start by moving the rear chassis fixture to the forward (buggy) position and remove the two small Phillips head screws on the top of the box as shown in Figure 1.

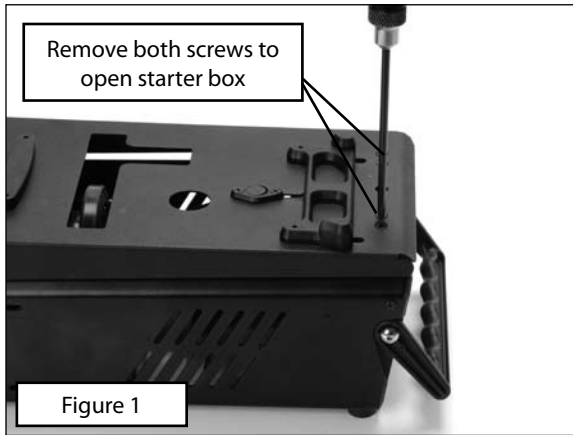

Two 7.2V Battery Packs

It is recommended to use 2 Losi 3600mAh 7.2V NiMH Performance batteries (LOSB9900) in the 8IGHT 2.0 Starter Box. By using the charger of your choice follow the manufacturers' directions to charge both batteries. On each side of the box there are two screws that hold the center battery mount into place. Remove these two screws on each side of the starter box for a total of four screws. This will loosen the center battery mount. The 6-cell stick packs will locate

into the plastic mounts on the rear of the battery box with a snug fit. Slide wires through center battery mount and fit center battery mount over each battery. Now screw all four screws back into place to secure the batteries.

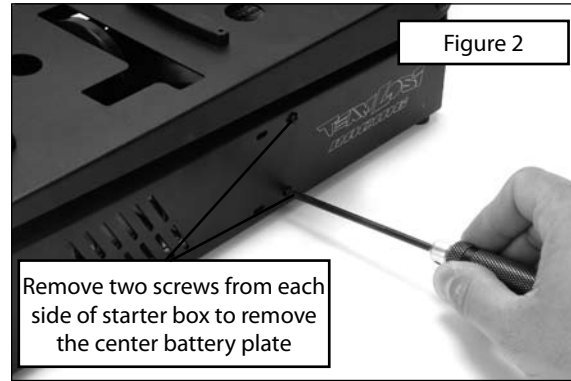

There are two locations to mount the 6-cell battery packs, a high and low location. There is no advantage to either location and it is personal preference.

High Location Battery Mount

With the batteries mounted in the high location it will be necessary to plug the batteries into the leads on the bottom side of the starter box as shown in Figure 4.

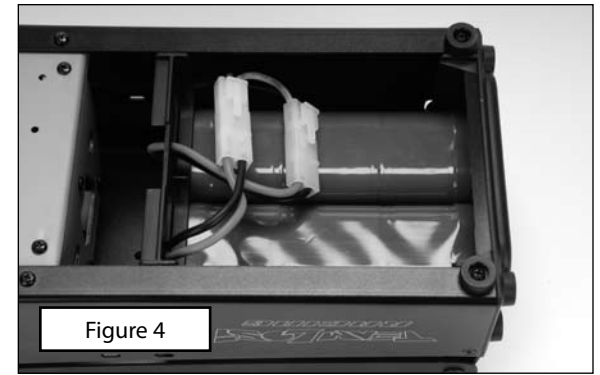
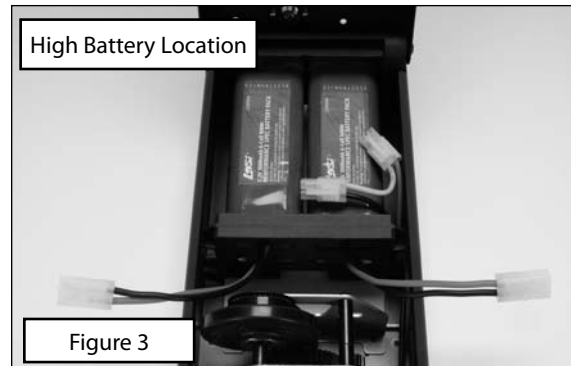

Low Location Battery Mount

In order to use this location you will have to use the plastic plate that is shown in Figure 5. This is used between the bottom of the starter box and the battery packs as seen in Figure 6. The plate will snap over the center battery mount to secure its location.

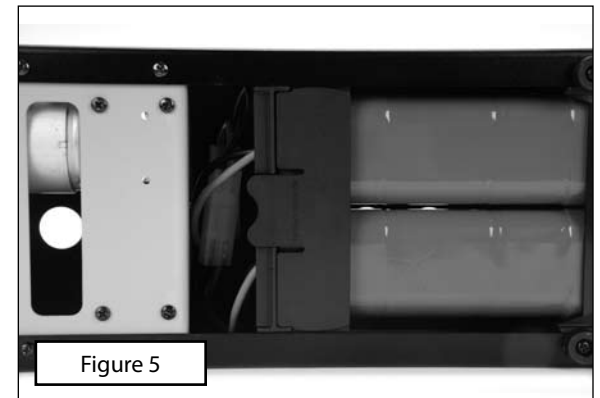
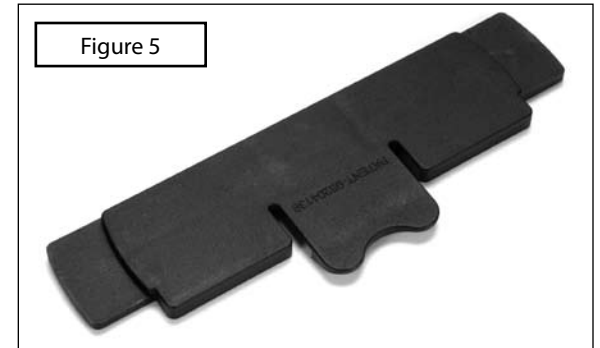

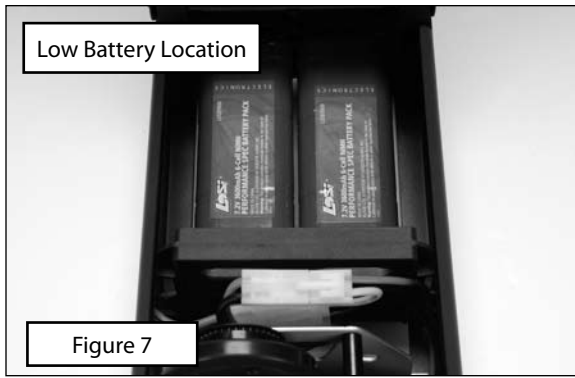

LiPo Battery

The 8IGHT 2.0 Starter Box is equipped with mounts to use the Losi 4S LiPo Starter Box battery pack (LOS9821, not included). By using the charger of your choice follow the manufacturer's directions to charge the battery. Insert the LiPo battery plates into oval inserts on each end, see Figure 8. These will locate into the starter box stick pack battery locations. Remove the four center battery plate screws and install the LiPo mounts into the top battery locations. Once the LiPo battery plates are installed the LiPo battery can be secured onto the plates with two zip ties, see Figure 11. Once the battery is installed plug the jumper plug (Figure 10) into one of the starter box connectors and the LiPo battery into the other, see Figure 11.

Please be aware when using a LiPo battery for your starter box power source that it is VERY important to not drain the battery completely as this will ruin the battery and may cause a fire. It is HIGHLY recommended to recharge the battery whenever you notice the battery power diminishing.

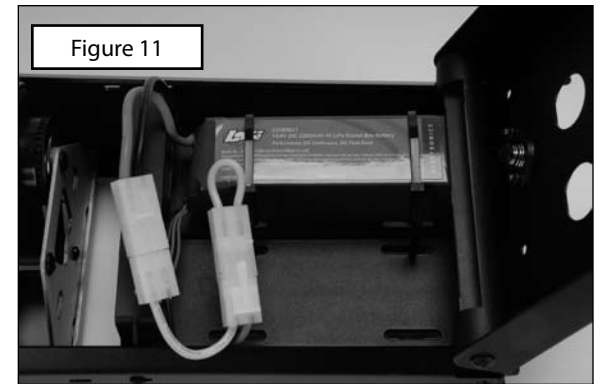
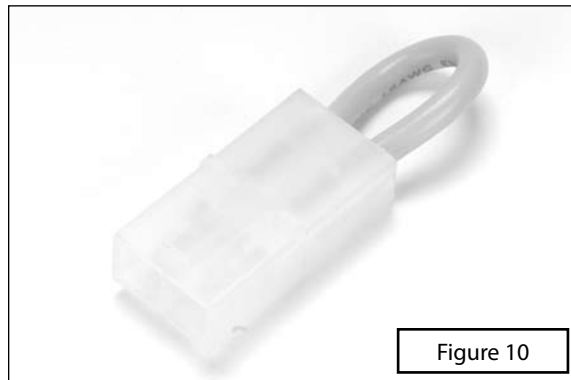
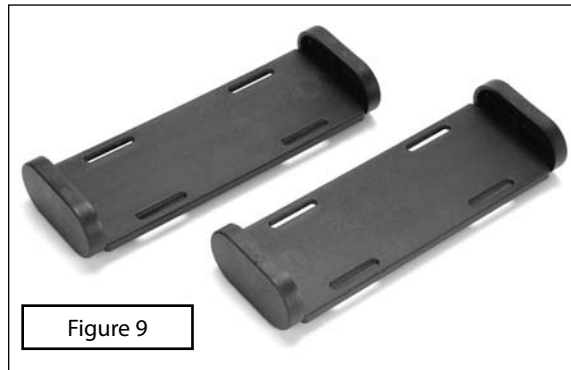
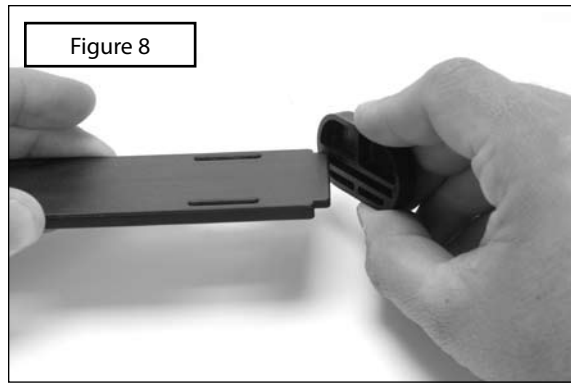

Adjusting the Chassis Fixtures

The Team Losi® Racing 8IGHT 2.0 Starter box accommodates both the 8IGHT 2.0 and 8IGHT-T 2.0 even though the vehicles have different chassis lengths. This is done by the front and rear chassis fixture. For the buggy rotate the front fixture with the "V" pointing toward the end of the starter box. Depress the lock button on the rear chassis fixture and move it towards the center of the starter box (short position) as shown in Figure 12.

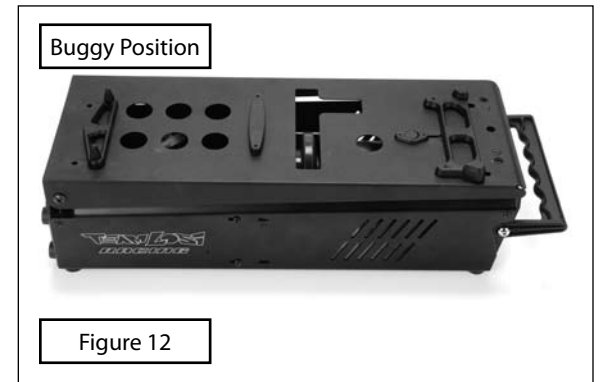

For the 8IGHT-T 2.0 Truggy location rotate the front fixture with the "V" pointing towards the center of the starter box. Depress the lock button on the rear fixture and push it to the end of the starter box (long position) as shown in Figure 13.

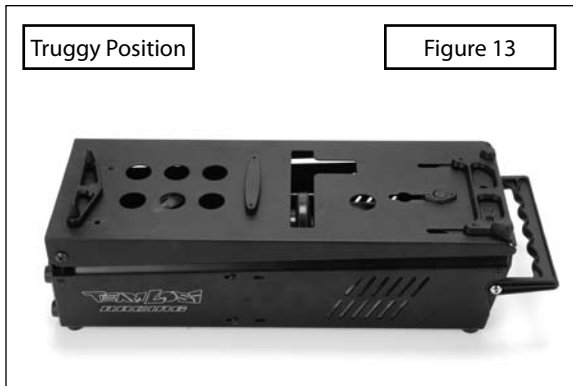

Starting the Vehicle

Place the chassis into the fixtures as shown in Figure 14. Note how the truggy chassis sits in the fixtures and the location of the starter wheel.

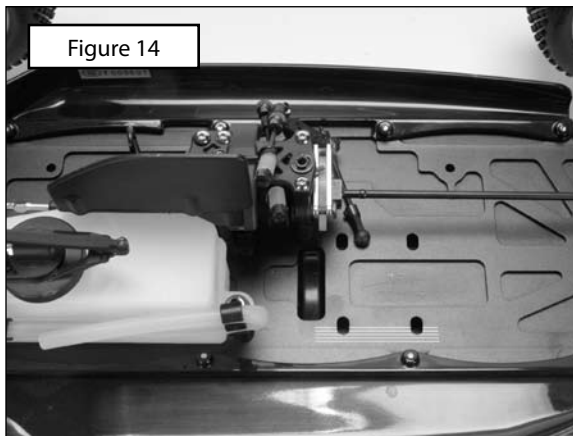

Turn the power switch to the "ON" position (Figure 15).



Press down on the rear of the chassis to engage the starter box wheel to the flywheel. After the engine starts, release the chassis. The vehicle will be able to sit on the starter box fixtures and idle without interference.

Note: If the engine is new, tight, or flooded, it may be necessary to loosen the glow plug 2-3 turns to get the engine to turn over. Retighten the glow plug after the engine starts to turn over. Do not continue to stall the starter box motor or allow the rubber wheel to grind on the flywheel of the engine. This will only decrease the life of your starter box motor and rubber wheel.

Troubleshooting Guide

Motor runs slow

- Battery(s) needs to be recharged

Starter wheel won't turn over engine

- Loosen glow plug
- Add a few drops of fuel into carburetor
- Check for excessive wear on starter wheel

Figure 15

Replacement Parts

Part #	Description	Price
LOSA3574	1.0 Module Pitch Pinion, 14T	\$9.99
LOSA99421	Starter Wheel: 8B/8T 2.0	\$3.99
LOSA99423	Starter Wheel Pulley Set: 8B/8T 2.0	\$7.99
LOSA99424	Starter Drive Belt: 8B/8T 2.0	\$8.99
LOSA99425	Starter Battery Mounting Plate Set: 8B/8T 2.0	\$7.99
LOSA99426	Starter Switch & Wire Hardware: 8B/8T 2.0	\$11.99
LOSA99427	Starter 775 Motor: 8B/8T 2.0	\$24.99
LOSA99428	Starter End Plates & Handle: 8B/8T 2.0	\$15.99
LOSA99429	Starter Chassis Fixture Set: 8B/8T 2.0	\$9.99

Warranty Information

WARRANTY PERIOD

Exclusive Warranty- Horizon Hobby, Inc., (Horizon) warranties that the Products purchased (the "Product") will be free from defects in materials and workmanship at the date of purchase by the Purchaser.

LIMITED WARRANTY

(a) This warranty is limited to the original Purchaser ("Purchaser") and is not transferable. REPAIR OR REPLACEMENT AS PROVIDED UNDER THIS WARRANTY IS THE EXCLUSIVE REMEDY OF THE PURCHASER. This warranty covers only those Products purchased from an authorized Horizon dealer. Third party transactions are not covered by this warranty. Proof of purchase is required for warranty claims. Further, Horizon reserves the right to change or modify this warranty without notice and disclaims all other warranties, express or implied.

(b) Limitations- HORIZON MAKES NO WARRANTY OR REPRESENTATION, EXPRESS OR IMPLIED, ABOUT NON-INFRINGEMENT, MERCHANTABILITY OR FITNESS FOR A PARTICULAR PURPOSE OF THE PRODUCT. THE PURCHASER ACKNOWLEDGES THAT THEY ALONE HAVE DETERMINED THAT THE PRODUCT WILL SUITABLY MEET THE REQUIREMENTS OF THE PURCHASER'S INTENDED USE.

(c) Purchaser Remedy- Horizon's sole obligation hereunder shall be that Horizon will, at its option, (i) repair or (ii) replace, any Product determined by Horizon to be defective. In the event of a defect, these are the Purchaser's exclusive remedies. Horizon reserves the right to inspect any and all equipment involved in a warranty claim. Repair or replacement decisions are at the sole discretion of Horizon. This warranty does not cover cosmetic damage or damage due to acts of God, accident, misuse, abuse, negligence, commercial use, or modification of or to any part of the Product. This warranty does not cover damage due to improper installation, operation, maintenance, or attempted repair by anyone other than Horizon. Return of any goods by Purchaser must be approved in writing by Horizon before shipment.

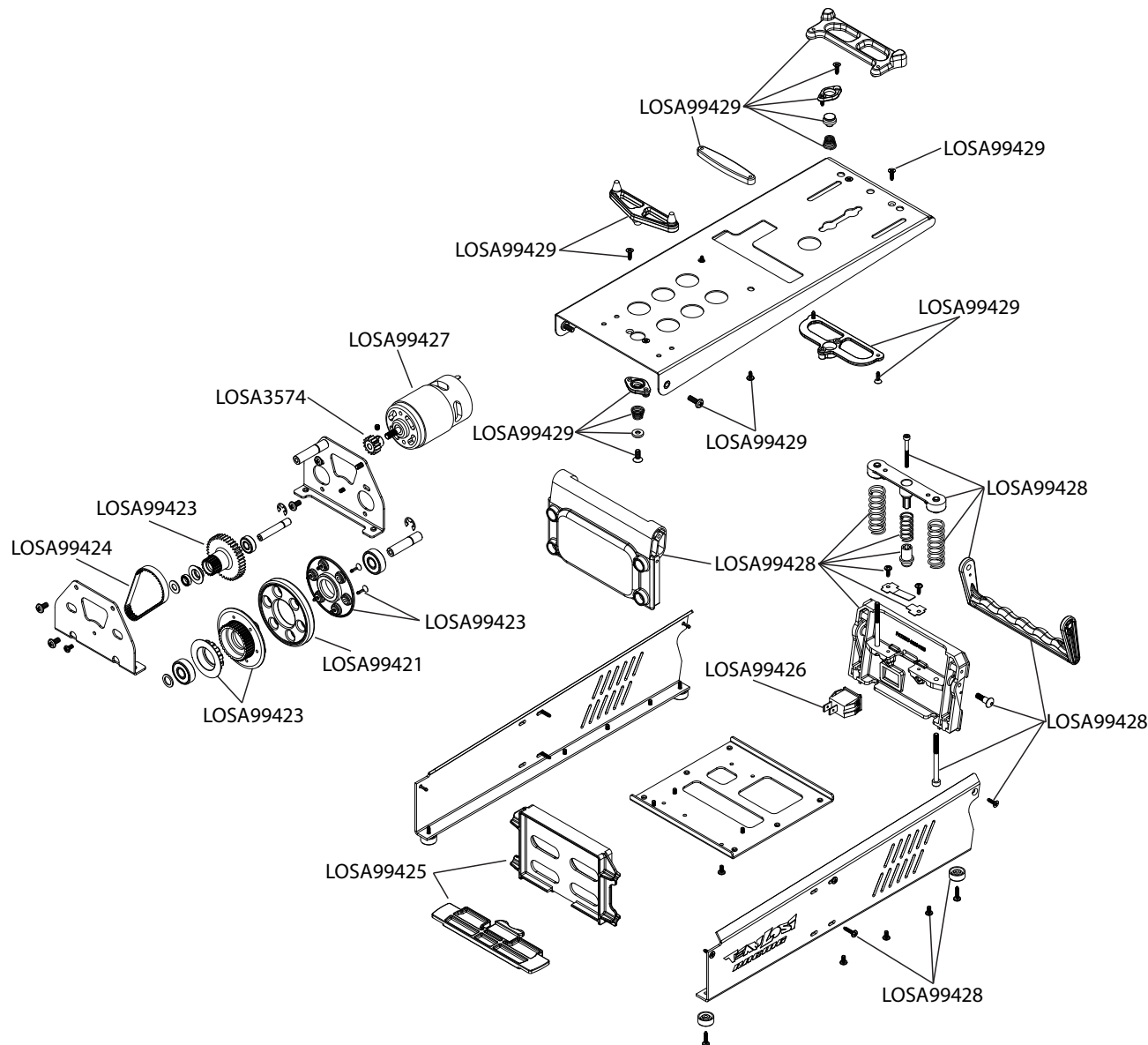

DAMAGE LIMITS

HORIZON SHALL NOT BE LIABLE FOR SPECIAL, INDIRECT OR CONSEQUENTIAL DAMAGES, LOSS OF PROFITS OR PRODUCTION OR COMMERCIAL LOSS IN ANY WAY CONNECTED WITH THE PRODUCT, WHETHER SUCH CLAIM IS BASED IN CONTRACT, WARRANTY, NEGLIGENCE, OR STRICT LIABILITY. Further, in no event shall the liability of Horizon exceed the individual price of the Product on which liability is asserted. As Horizon has no control over use, setup, final assembly, modification or misuse, no liability shall be assumed nor accepted for any resulting damage or injury. By the act of use, setup or assembly, the user accepts all resulting liability.

If you as the Purchaser or user are not prepared to accept the liability associated with the use of this Product, you are advised to return this Product immediately in new and unused condition to the place of purchase.

Law: These Terms are governed by Illinois law (without regard to conflict of law principles).

SAFETY PRECAUTIONS

This is a sophisticated hobby Product and not a toy. It must be operated with caution and common sense and requires some basic mechanical ability. Failure to operate this Product in a safe and responsible manner could result in injury or damage to the Product or other property. This Product is not intended for use by children without direct adult supervision. The Product manual contains instructions for safety, operation and maintenance. It is essential to read and follow all the instructions and warnings in the manual, prior to assembly, setup or use, in order to operate correctly and avoid damage or injury.

QUESTIONS, ASSISTANCE, AND REPAIRS

Your local hobby store and/or place of purchase cannot provide warranty support or repair. Once assembly, setup or use of the Product has been started, you must contact Horizon directly. This will enable Horizon to better answer your questions and service you in the event that you may need any assistance. For questions or assistance, please direct your email to productsupport@horizonhobby.com, or call 877.504.0233 toll free to speak to a service technician.

INSPECTION OR REPAIRS

If this Product needs to be inspected or repaired, please call for a Return Merchandise Authorization (RMA). Pack the Product securely using a shipping carton. Please note that original boxes may be included, but are not designed to withstand the rigors of shipping without additional protection. Ship via a carrier that provides tracking and insurance for lost or damaged parcels, as Horizon is not responsible for merchandise until it arrives and is accepted at our facility. A Service Repair Request is available at www.horizonhobby.com on the "Support" tab. If you do not have internet access, please include a letter with your complete name, street address, email address and phone number where you can be reached during business days, your RMA number, a list of the included items, method of payment for any non-warranty expenses and a brief summary of the problem. Your original sales receipt must also be included for warranty consideration. Be sure your name, address, and RMA number are clearly written on the outside of the shipping carton.

WARRANTY INSPECTION AND REPAIRS

To receive warranty service, you must include your original sales receipt verifying the proof-of-purchase date. Provided warranty conditions have been met, your Product will be repaired or replaced free of charge. Repair or replacement decisions are at the sole discretion of Horizon Hobby.

NON-WARRANTY REPAIRS

Should your repair not be covered by warranty the repair will be completed and payment will be required without notification or estimate of the expense unless the expense exceeds 50% of the retail purchase cost. By submitting the item for repair you are agreeing to payment of the repair without notification. Repair estimates are available upon request. You must include this request with your repair. Non-warranty repair estimates will be billed a minimum of 1/2 hour of labor. In addition you will be billed for return freight. Please advise us of your preferred method of payment. Horizon accepts money orders and cashiers checks, as well as Visa, MasterCard, American Express, and Discover cards. If you choose to pay by credit card, please include your credit card number and expiration date. Any repair left unpaid or unclaimed after 90 days will be considered abandoned and will be disposed of accordingly. Please note: non-warranty repair is only available on electronics and model engines.

United States:

Electronics and engines requiring inspection or repair should be shipped to the following address:

Horizon Service Center
4105 Fieldstone Road
Champaign, Illinois 61822
USA

All other Products requiring warranty inspection or repair should be shipped to the following address:

Horizon Product Support
4105 Fieldstone Road
Champaign, Illinois 61822
USA

Please call 877-504-0233 or e-mail us at productsupport@horizonhobby.com with any questions or concerns regarding this product or warranty.

United Kingdom:

Electronics and engines requiring inspection or repair should be shipped to the following address:

Horizon Hobby UK
Units 1-4 Ployters Rd
Staple Tye
Harlow, Essex
CM18 7NS
United Kingdom

Please call +44 (0) 1279 641 097 or e-mail us at sales@horizonhobby.co.uk with any questions or concerns regarding this product or warranty.

CE Compliance Information for the European Union

INSTRUCTIONS FOR DISPOSAL OF WEEE BY USERS IN THE EUROPEAN UNION

This product must not be disposed of with other waste. Instead, it is the user's responsibility to dispose of their waste equipment by handing it over to a designated collection point for the recycling of waste electrical and electronic equipment. The separate collection and recycling of your waste equipment at the time of disposal will help to conserve natural resources and ensure that it is recycled in a manner that protects human health and the environment. For more information about where you can drop off your waste equipment for recycling, please contact your local city office, your household waste disposal service or where you purchased the product.



Declaration of Conformity

(in accordance with ISO/IEC 17050-1)

No. HH20090721

Product(s): 8IGHT 2.0/8IGHT-T 2.0 Starter Box
Item Number(s): LOSA99059
Equipment class: 1

The object of declaration described above is in conformity with the requirements of the specifications listed below, following the provisions of the European EMC Directive 2004/108/EC:

- EN55022 Radio disturbance characteristics
- EN55024 Immunity characteristics

Signed for and on behalf of:

Horizon Hobby, Inc.
Champaign, IL USA
July 21, 2009

Steven A. Hall

A handwritten signature in black ink that reads "Steven A. Hall".

Vice President
International Operations and Risk Management
Horizon Hobby, Inc.



800-0400

©2009 Losi, A division of Horizon Hobby, Inc.

Printed 06/09