

**TEAM LOSI®**  
**RACING**  
**Universal 1/8**  
**Starter Box**  
**LOSA99062**

**Installing the battery**

You have several battery options to power your starter box. You can use 7.2V Ni-Cd or Ni-MH battery packs or a single 12V gel cell. Preamsembled wiring harnesses and mounting fixtures for both of these options are included. Please note the proper mounting and wiring layout in Images 2 and 3. Start by removing the small Phillips head screw on the top of the box as shown in Photo 1.

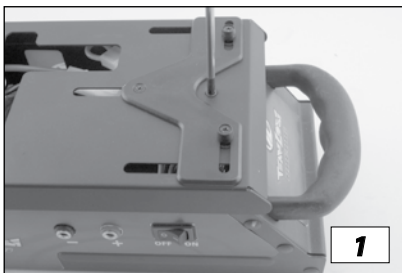

**Two 7.2V battery packs**

Install the holder and packs as seen in Image 2 and the wiring diagram elsewhere.

**Note:** The plugs are keyed so they can only be installed one way.

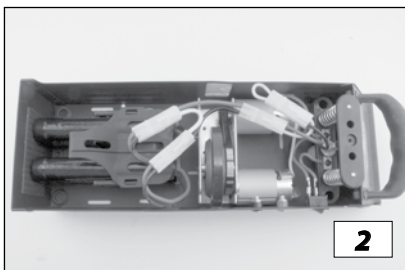

**Gel Cell**

Install the holder and gel cell as seen in Photo 3 and in the wiring diagram.

**Note:** The Red (+) and Black (-) terminals on the battery. Unless you plan on using the power terminals next to the switch, you must tape and/or cut the ends of the loose battery leads. Do not leave these exposed as they can easily short out the battery and cause damage and a safety hazard.

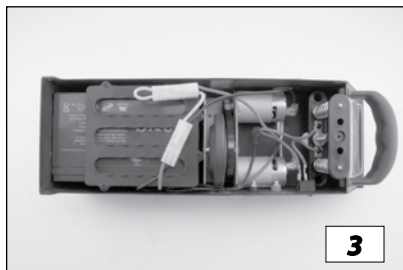

**Adjusting the chassis fixtures**

Open the top and loosen the four Phillips head screws that secure the chassis fixtures as seen in the photo.

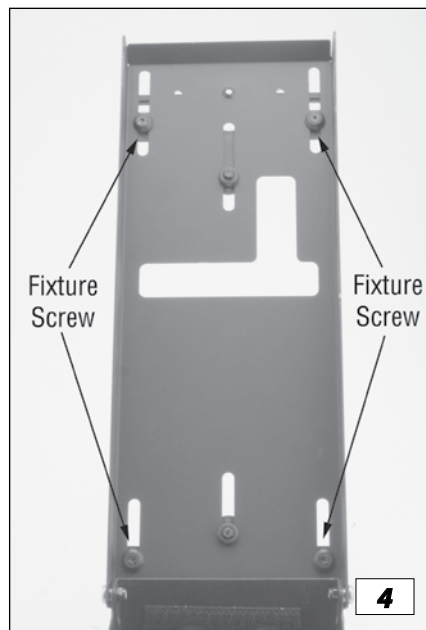

Close the top and loosen the Phillips screws in the locating fixture pegs and the at the center of the fixture for both the front and rear fixtures..

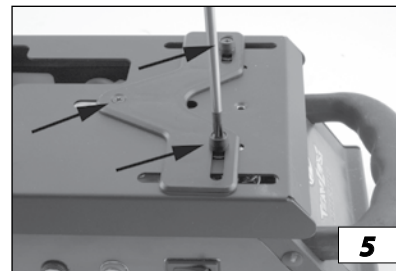

Slide the locating pegs on the fixtures all the way out to the end and the fixtures as far out from center as they will go.

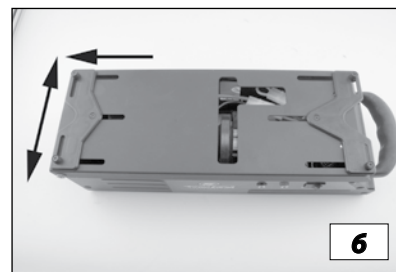

With the engine removed, place the chassis straight on the starter box (see photo 11) so the starter wheel in the box is centered directly below the opening in the chassis where the engine flywheel would reside. Make sure the starter wheel is centered left to right as well as front to rear so it will not rub on the chassis.

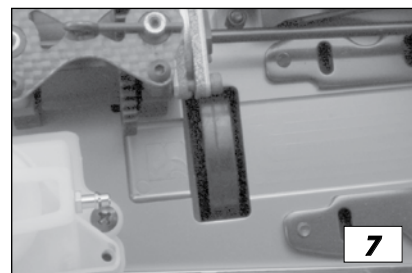

Pick up the chassis first at the rear and then at the front sliding the locating fixture inward until the locating pegs are behind the front arms and in front of the rear arms as seen in Photos 8 and 9.

With the chassis still in place slide the locating pegs inward on each side until they are sitting where the chassis meets the pivot block. Tighten the Phillips head screws in the pegs.

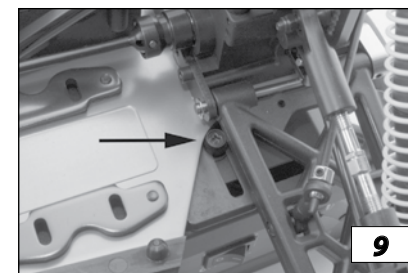

Check to make sure the starter wheel is still centered in the opening for the engine flywheel and lift the chassis straight up. Use a piece of tape to hold the fixtures and tighten the center fixture screws. Replace the chassis into the fixtures to confirm the fit and that the starter wheel is still centered directly below the chassis cutout for the flywheel. Make any adjustments necessary until both the fit and centering are correct.

Open the box top and tighten the four fixture locating screws to lock them in place as seen in Photo 4.

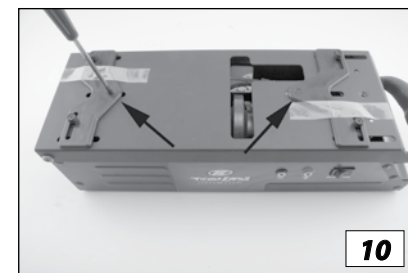

## Starting

Before starting for the first time: follow these instructions without the chassis on the starter allowing the motors to run for 20-30 seconds at least 5 times to help the brushes seat in.

Place the chassis into the fixtures as seen in the image below.

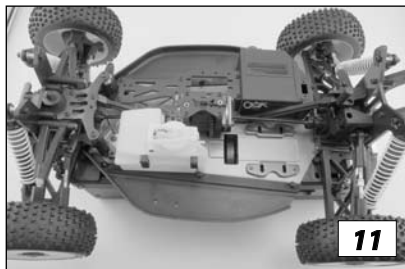

Turn the power switch to the "ON" position.



Press down on the back of the chassis which should power up the motors a little before the starter wheel engages the flywheel on the engine. Always check to be sure that the rubber wheel is not hitting the chassis or you will overheat the motors and damage the rubber wheel. If the engine doesn't start after 5 to 6 seconds stop and check for fuel, glow igniter etc before continuing. Never turn the engine over for more than 10 seconds at a time without letting the motors rest. If it doesn't start there is something wrong and continuing to turn it over will not help—only overheat the motors. If there is not adequate power there may not be enough time between the motors powering up and the starter wheel engaging the flywheel. Go to "Adjusting the starter switch" and adjust this as necessary. As the motors break in and the wheel wears you will gain starting power.

After the engine starts, release the chassis – it should sit in the fixtures and idle without interference. Turn "OFF" the power switch when not in use.

**Note:** If the engine is new, tight, or flooded, it may be necessary to loosen the glow plug 2-3 turns to get it turning over. Re-tighten after engine starts turning over. Do not continue to stall the motors or allow the rubber wheel to grind on the flywheel or chassis.

## Adjusting the starter switch

You can adjust the starter switch and the point at which the motors start running by turning the Phillips head adjustment screw (accessible through the hole in the bottom of box as seen below).

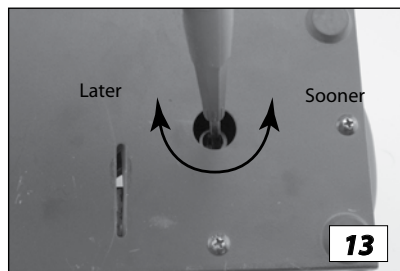

Turning the adjustment screw counterclockwise will allow the motors to start sooner and have better starting power. Turning the adjustment screw clockwise will start the motors later and give you more travel before the motors start to power up. You may want to adjust this to compensate for starter wheel wear.

Ideally, the motors should start when the top plate is depressed about 1/8-inch. If you find that the motors are easily stalled while trying to start your engine, adjust the starter switch as noted above so that the motors start sooner.

## Troubleshooting Guide

### Motors run slow

Wheel rubbing on chassis  
Motors overheated—let cool  
Battery(s) needs to be charged

### Starter wheel won't turn over engine

Loosen glow plug  
Adjust switch so motors start sooner  
Put a few drops of fuel in carburetor  
Check for wheel interference with chassis (See Photo 7)  
Check for starter wheel wear

## Tech/Service Tips

- On some models it may be necessary to relieve the ends of the flywheel opening on the bottom of your chassis (as seen below) to prevent the chassis from interfering with the starter wheel and allow the wheel easy access to engage the flywheel on the engine.

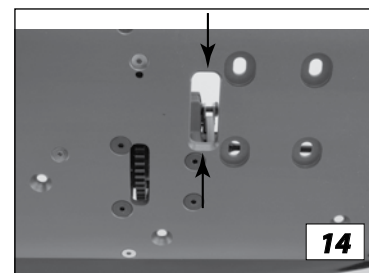

- It's a good idea to use compressed air to clean the dust and dirt out of the starter box.
- To replace the starter wheel, remove the four screws in the center of the box bottom as seen below.

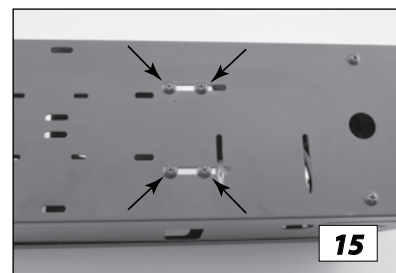

Disconnect the wires from the motor and mark the location of the flywheel screws before removing. Remove the screws on either side of the wheel shaft. After replacing the wheel, be sure to re-install the assembly in its original position.

## Warranty Period

Exclusive Warranty- Horizon Hobby, Inc., (Horizon) warrants that the Products purchased (the "Product") will be free from defects in materials and workmanship at the date of purchase by the Purchaser.

## Limited Warranty

(a) This warranty is limited to the original Purchaser ("Purchaser") and is not transferable. REPAIR OR REPLACEMENT AS PROVIDED UNDER THIS WARRANTY IS THE EXCLUSIVE REMEDY OF THE PURCHASER. This warranty covers only those Products purchased from an authorized Horizon dealer. Third party transactions are not covered by this warranty. Proof of purchase is required for warranty claims. Further, Horizon reserves the right to change or modify this warranty without notice and disclaims all other warranties, express or implied.

(b) Limitations- HORIZON MAKES NO WARRANTY OR REPRESENTATION, EXPRESS OR IMPLIED, ABOUT NON-INFRINGEMENT, MERCHANTABILITY OR FITNESS FOR A PARTICULAR PURPOSE OF THE PRODUCT. THE PURCHASER ACKNOWLEDGES THAT THEY ALONE HAVE DETERMINED THAT THE PRODUCT WILL SUITABLY MEET THE REQUIREMENTS OF THE PURCHASER'S INTENDED USE.

(c) Purchaser Remedy- Horizon's sole obligation hereunder shall be that Horizon will, at its option, (i) repair or (ii) replace, any Product determined by Horizon to be defective. In the event of a defect, these are the Purchaser's exclusive remedies. Horizon reserves the right to inspect any and all equipment involved in a warranty claim. Repair or replacement decisions are at the sole discretion of Horizon. This warranty does not cover cosmetic damage or damage due to acts of God, accident, misuse, abuse, negligence, commercial use, or modification of or to any part of the Product. This warranty does not cover damage due to improper installation, operation, maintenance, or attempted repair by anyone other than Horizon. Return of any goods by Purchaser must be approved in writing by Horizon before shipment.

## Damage Limits

HORIZON SHALL NOT BE LIABLE FOR SPECIAL, INDIRECT OR CONSEQUENTIAL DAMAGES, LOSS OF PROFITS OR PRODUCTION OR COMMERCIAL LOSS IN ANY WAY CONNECTED WITH THE PRODUCT, WHETHER SUCH CLAIM IS BASED IN CONTRACT, WARRANTY, NEGLIGENCE, OR STRICT LIABILITY. Further, in no event shall the liability of Horizon exceed the individual price of the Product on which liability is asserted. As Horizon has no control over use, setup, final assembly, modification or misuse, no liability shall be assumed nor accepted for any resulting damage or injury. By the act of use, setup or assembly, the user accepts all resulting liability.

If you as the Purchaser or user are not prepared to accept the liability associated with the use of this Product, you are advised to return this Product immediately in new and unused condition to the place of purchase.

Law: These Terms are governed by Illinois law (without regard to conflict of law principals).

## Safety Precautions

This is a sophisticated hobby Product and not a toy. It must be operated with caution and common sense and requires some basic mechanical ability. Failure to operate this Product in a safe and responsible manner could result in injury or damage to the Product or other property. This Product is not intended for use by children without direct adult supervision. The Product manual contains instructions for safety, operation and maintenance. It is essential to read and follow all the instructions and warnings in the manual, prior to assembly, setup or use, in order to operate correctly and avoid damage or injury.

## Questions, Assistance, and Repairs

Your local hobby store and/or place of purchase cannot provide warranty support or repair. Once assembly, setup or use of the Product has been started, you must contact Horizon directly. This will enable Horizon to better answer your questions and service you in the event that you may need any assistance. For questions or assistance, please direct your email to [productsupport@horizonhobby.com](mailto:productsupport@horizonhobby.com), or call 877.504.0233 toll free to speak to a service technician.

## Inspection or Repairs

If this Product needs to be inspected or repaired, please call for a Return Merchandise Authorization (RMA). Pack the Product securely using a shipping carton. Please note that original boxes may be included, but are not designed to withstand the rigors of shipping without additional protection. Ship via a carrier that provides tracking and insurance for lost or damaged parcels, as **Horizon is not responsible for merchandise until it arrives and is accepted at our facility.** A Service Repair Request is available at [www.horizonhobby.com](http://www.horizonhobby.com) on the "Support" tab. If you do not have internet access, please include a letter with your complete name, street address, email address and phone number where you can be reached during business days, your RMA number, a list of the included items, method of payment for any non-warranty expenses and a brief summary of the problem. Your original sales receipt must also be included for warranty consideration. Be sure your name, address, and RMA number are clearly written on the outside of the shipping carton.

## Warranty Inspection and Repairs

**To receive warranty service, you must include your original sales receipt** verifying the proof-of-purchase date. Provided warranty conditions have been met, your Product will be repaired or replaced free of charge. Repair or replacement decisions are at the sole discretion of Horizon Hobby.

## Wiring Diagram

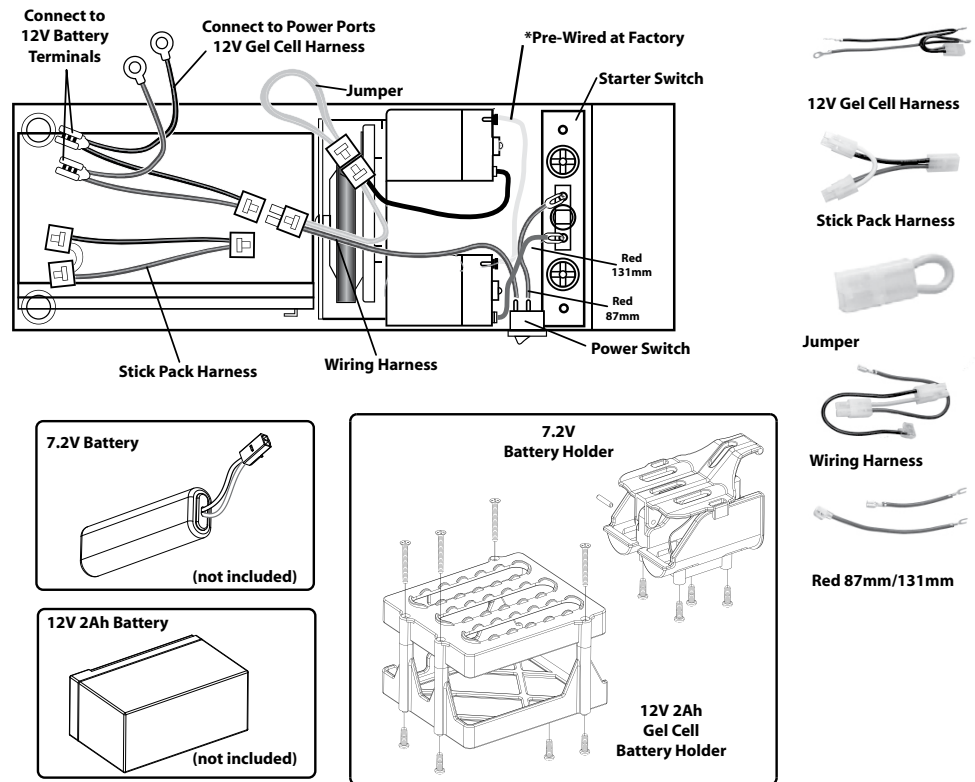

## Non-Warranty Repairs

**Should your repair not be covered by warranty the repair will be completed and payment will be required without notification or estimate of the expense unless the expense exceeds 50% of the retail purchase cost.** By submitting the item for repair you are agreeing to payment of the repair without notification. Repair estimates are available upon request. You must include this request with your repair. Non-warranty repair estimates will be billed a minimum of ½ hour of labor. In addition you will be billed for return freight. Please advise us of your preferred method of payment. Horizon accepts money orders and cashiers checks, as well as Visa, MasterCard, American Express, and Discover cards. If you choose to pay by credit card, please include your credit card number and expiration date. Any repair left unpaid or unclaimed after 90 days will be considered abandoned and will be disposed of accordingly. **Please note: non-warranty repair is only available on electronics and model engines.**

Electronics requiring inspection or repair should be shipped to the following address:

Horizon Service Center  
4105 Fieldstone Road  
Champaign, Illinois 61822

All other Products requiring warranty inspection or repair should be shipped to the following address:

Contact Losi:  
4710 East Guasti Road  
Ontario, CA 91761  
(909)390-9595  
[feedback@teamlosi.com](mailto:feedback@teamlosi.com)

**Please call 877-504-0233 with any questions or concerns regarding this product or warranty.**

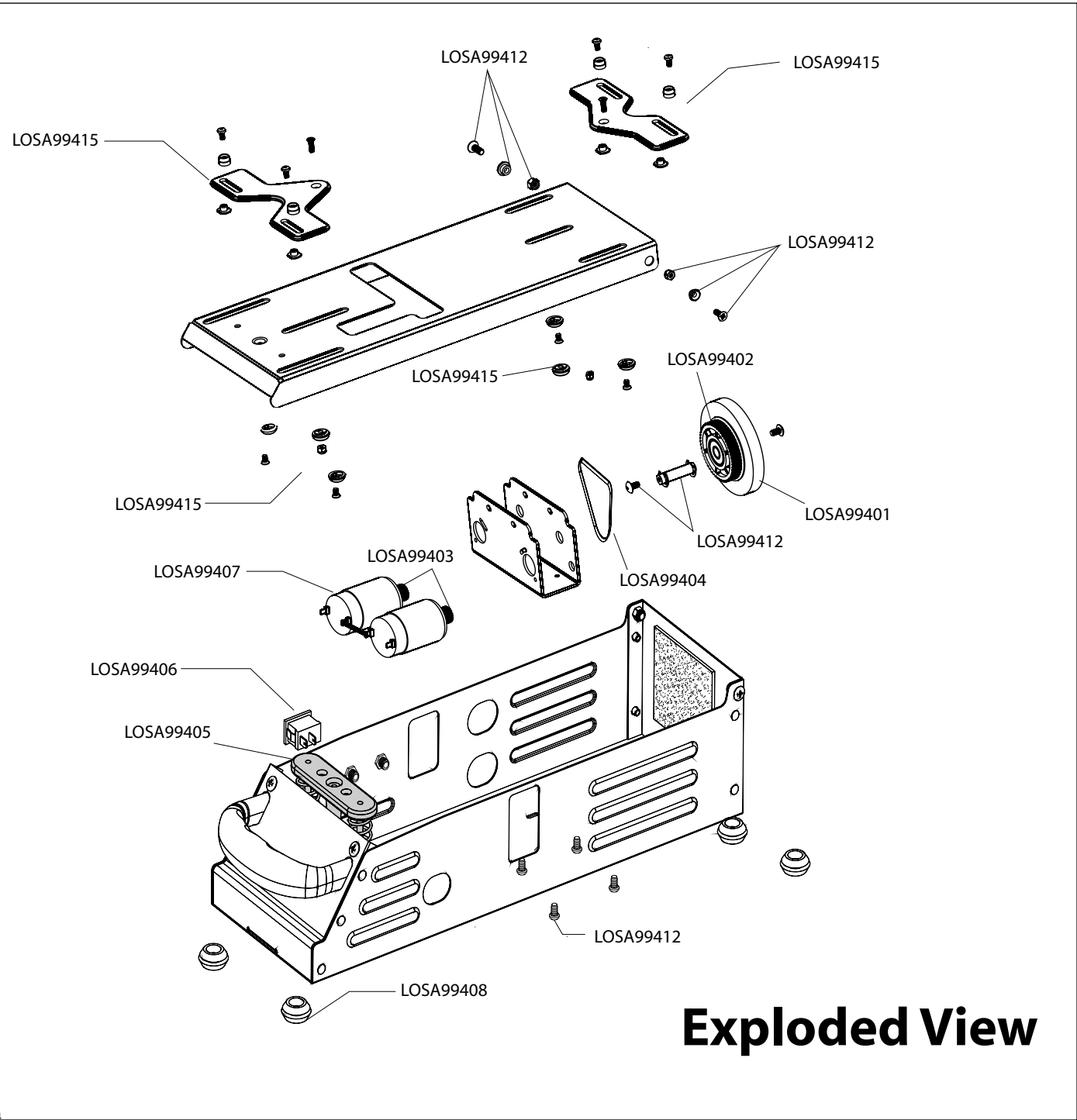

## Replacement Parts

Part #	Description	Price
LOSA99401	Starter Box Wheel	\$3.99
LOSA99402	Starter Box Pulley	\$4.99
LOSA99403	Motor Pulley Set	\$2.99
LOSA99404	Starter Drive Belt	\$7.99
LOSA99405	Starter Switch Set—Adjustable	\$6.99
LOSA99406	Power Switch	\$2.50
LOSA99407	Starter 550 Motor w/Pulley	\$14.99
LOSA99408	Starter Rubber Feet (4ea)	\$2.99
LOSA99412	Starter Misc Hardware Set	\$3.50
LOSA99415	Univ. Front & Rear Fixtures	\$13.99

©2007 Team Losi Racing is an exclusive brand of  
 Horizon Hobby, Inc.  
 4105 Fieldstone Rd.  
 Champaign, IL 61822  
 Customer Support  
 1-877-504-0233  
[www.horizonhobby.com](http://www.horizonhobby.com)  
[www.losi.com](http://www.losi.com)