

Name: <u>Mike Truhe</u>		Date: <u>9.21.08</u>	Event: <u>IFMAR World Champs</u>
City: <u>Charlotte</u>		State: <u>NC</u>	
Track: <u>The Farm 2</u>			

Track	<input type="checkbox"/> Indoor	<input type="checkbox"/> Tight	<input type="checkbox"/> Smooth	<input checked="" type="checkbox"/> Hard Packed	<input type="checkbox"/> Blue Groove	<input type="checkbox"/> Wet	<input type="checkbox"/> Low Bite	<input type="checkbox"/> High Bite
Conditions	<input checked="" type="checkbox"/> Outdoor	<input checked="" type="checkbox"/> Open	<input checked="" type="checkbox"/> Rough	<input type="checkbox"/> Loose/Loamy	<input checked="" type="checkbox"/> Dry	<input type="checkbox"/> Dusty	<input checked="" type="checkbox"/> Med Bite	<input type="checkbox"/> Other _____

Front Suspension

Toe: 2 Degree Toe Out

Ride Height: 27mm

Camber: -2 Degrees

Caster: Stock

Sway Bar: 2.3mm

Piston/Oil: 54/40wt Losi

Spring: Silver

Limiter/Droop: _____

Overall Shock Length: 95mm

Steering Ackerman: Long

Bump Steer: Down

Camber Link: 2/A

Shock Location: 2/Inside

Receiver Battery Type: Losi LiPo

Differentials

Front: ☒ Standard ☐ Smart

Spring Wire Dia: n/a

Qty of Springs: n/a

Ramp Plate: n/a

Grease: n/a

Diff Fluid: 5000wt

Center: ☒ Standard ☐ Smart

Spring Wire Dia: n/a

Qty of Springs: n/a

Ramp Plate: n/a

Grease: n/a

Diff Fluid: 7000wt

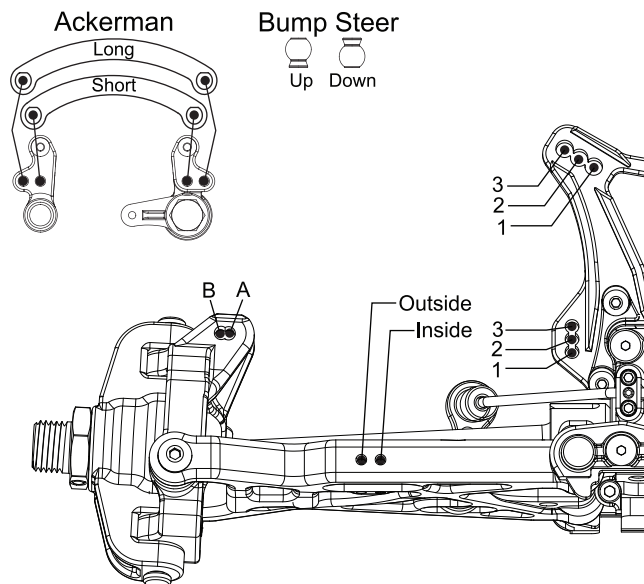

Notes: _____

Rear Suspension

Toe: 3 Degrees

Anti-Squat: 3 Degrees

Ride Height: 29mm

Camber: -1 Degree

Rear Hub Spacing: Hubs in back position.

Sway Bar: 2.3mm

Piston/Oil: 56/25wt Losi

Spring: Green

Limiter/Droop: _____

Overall Shock Length: 106mm

Camber Link: 2/B

Shock Location: 2/Inside

Rear Diff Fluid: 2000wt

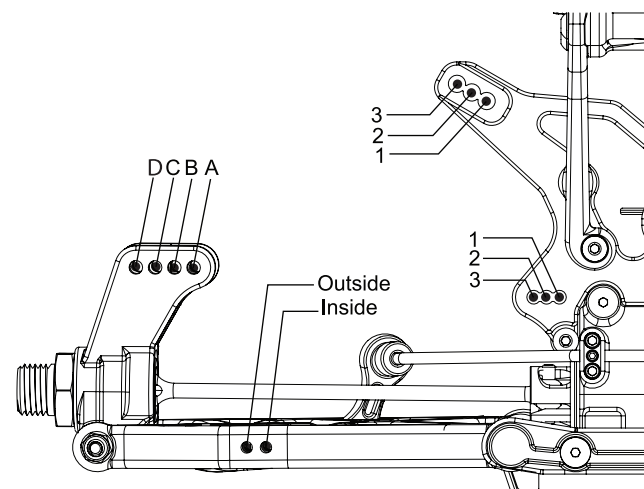

Notes: Top Qualifier Finished 2nd

Used new 8IGHT 2.0 body to reduce engine temp

by 10 degrees

Engine

Engine: GRP .21 Mario Rossi Tuned Fuel: Nitrotane 30%

Glow Plug: GRP C4 Head Clearance: _____

Pipe/Header: GRP 2053 Gearing: 13/48

Clutch

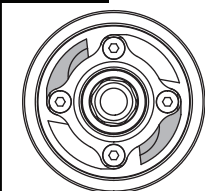

Clutch Shoes and Springs Info

2 Aluminum with Gold Springs

2 Plastic with Green Springs

Steel Flywheel

Tires

	Type	Compound	Insert
Front:	<u>Losi Eclipse</u>	<u>Red</u>	<u>Losi Yellow</u>
Rear:	<u>Losi Eclipse</u>	<u>Red</u>	<u>Losi Yellow</u>

Notes: _____
