

Name: Mike Truhe  
 City: Charlotte State: NC  
 Country:  
 E-mail:  
 Phone:

Date: 8.18.07 Event: ROAR Gas Truck Nationals  
 Track: The Farm 2  
 Qualified: 1st Finish:  
 Best Lap Time / sec : Avg. Lap Time / sec :  
 Note:

Track Conditions		
Time	Air Temp	Track Temp
: am pm	°F or °C	°F or °C
<input type="checkbox"/> Indoor <input checked="" type="checkbox"/> Outdoor	<input type="checkbox"/> Tight <input checked="" type="checkbox"/> Open	Race Length (min) 45
<input type="checkbox"/> Wet <input checked="" type="checkbox"/> Dry <input type="checkbox"/> Dusty	<input type="checkbox"/> Smooth <input checked="" type="checkbox"/> Rough <input checked="" type="checkbox"/> Hard Packed <input type="checkbox"/> Loose/Loomy <input type="checkbox"/> Blue Groove	<input checked="" type="checkbox"/> Low Bite <input type="checkbox"/> Med Bite <input type="checkbox"/> High Bite

### Front Suspension

Toe  In 1 ° Camber  - 1 °  
 Out \_\_\_\_\_ °  + \_\_\_\_\_ °  
 Ride Height 31mm

**Front Shocks**  
 Oil Wt. 35  
 Oil Brand LOSI  
 Piston 566  STD  Drilled  
 Spring Yellow  
 Limiters:  
 Inside .230"  
 Outside \_\_\_\_\_  
 Notes: \_\_\_\_\_

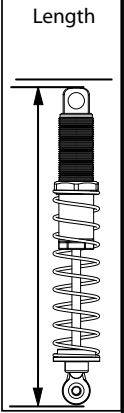
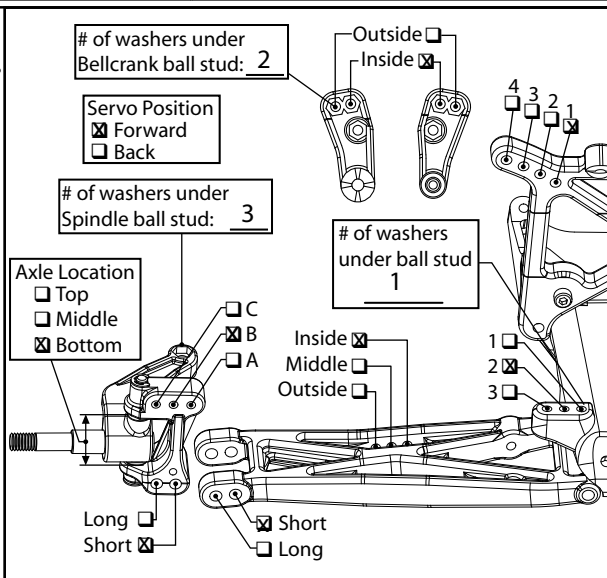



NOTES: \_\_\_\_\_  
 1/4 ounce of weight in front bulkhead  
 .100" axle spacers on front axles to make truck wider  
 566 piston is accomplished by drilling one hole of a 56 piston to 55 using a #55 drill bit

### Rear Suspension

Camber  - 0 °  + \_\_\_\_\_ °  
 Ride Height 30mm

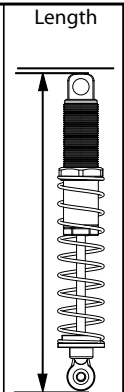
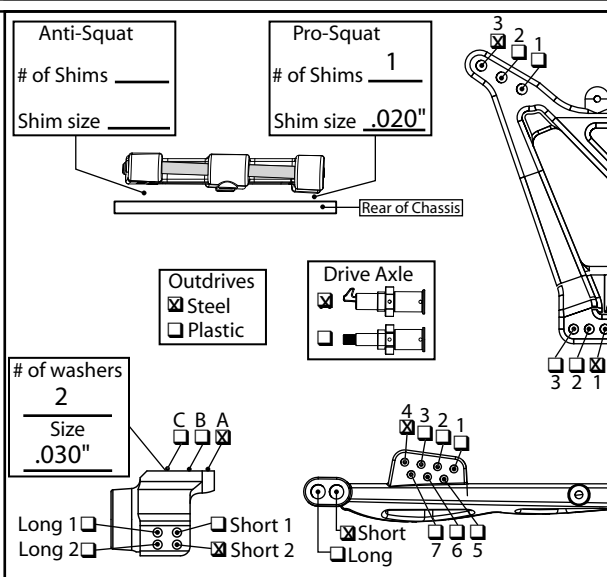
**Rear Shocks**  
 Oil Wt. 30  
 Oil Brand LOSI  
 Piston 55  STD  Drilled  
 Spring Yellow  
 Limiters:  
 Inside 0  
 Outside \_\_\_\_\_  
 Notes: \_\_\_\_\_

NOTES: \_\_\_\_\_  
 1/2 ounce of weight in battery box  
 Used new .125" longer chassis and brace  
 Used .100" wider offset for rear axle

Body AD2  
 Spoiler:  Yes  No Size: ROAR  
 Throttle Servo Airtronics 94737  
 Steering Servo Airtronics 94360  
 RX Pack Dynamite 1400mah  
 Transponder Location Front bulkhead

Engine Novarossi  
 Carb  Slide  Rotary - Brand: \_\_\_\_\_  
 Glow Plug Dynamite MC59  
 Head Clearance \_\_\_\_\_  
 Engine Temp \_\_\_\_\_

Spur/Clutch Bell 51 / 19  
 Fuel Nitrotane Nitro % 20  
 Carb Restrictor  None  .170  .180  .190  
 Minutes per tank 9  
 Muffler Type Losi Drake  
 Manifold Type Losi

Clutch  Stock  Other \_\_\_\_\_  
 Sprung  Unsprung  
 Shade were clutch was cut or lightened  Trailing  Leading  
 Notes \_\_\_\_\_

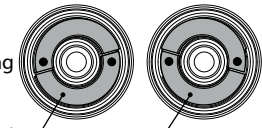

Weight Placement (mark with "X")  
 Weight of each piece \_\_\_\_\_ oz.  
 Vehicle Weight \_\_\_\_\_

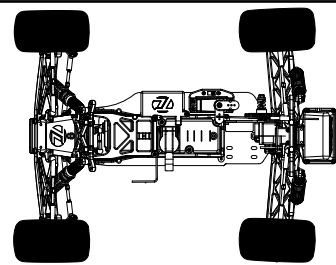

Tires: Brand Compound Insert Additive  
 Front: Losi Directionals Red Losi  
 Rear: Losi Ifmar Pins Red Losi  
 NOTES: \_\_\_\_\_  
