

Name: Adam Drake

Date: July 19th, 2009

Event: ROAR Nationals

City: Joliet State: IL

Track: Leisure Hours Raceway

Track ☐ Indoor ☒ Tight ☒ Smooth ☒ Hard Packed ☒ Blue Groove ☐ Wet ☐ Low Bite ☐ High Bite  
Conditions ☒ Outdoor ☐ Open ☐ Rough ☐ Loose/Loamy ☒ Dry ☐ Dusty ☒ Med Bite ☐ Other \_\_\_\_\_

## Front Suspension

Toe: 3 Degree Toe Out  
Ride Height: 27mm  
Camber: -1 Degrees  
Caster: Stock  
Sway Bar: 2.3mm  
Piston/Oil: 54 (drilled)/40wt Losi  
Spring: Silver  
Limiter/Droop: \_\_\_\_\_  
Overall Shock Length: 95mm  
Steering Ackerman: Long  
Bump Steer: Down  
Camber Link: 2/A  
Shock Location: 2/Inside  
Receiver Battery Type: Losi

## Differentials

Front: ☒ Standard ☐ Smart  
Spring Wire Dia: n/a  
Qty of Springs: n/a  
Ramp Plate: n/a  
Grease: n/a  
Diff Fluid: 5000wt  
Center: ☒ Standard ☐ Smart  
Spring Wire Dia: n/a  
Qty of Springs: n/a  
Ramp Plate: n/a  
Grease: n/a  
Diff Fluid: 7000wt

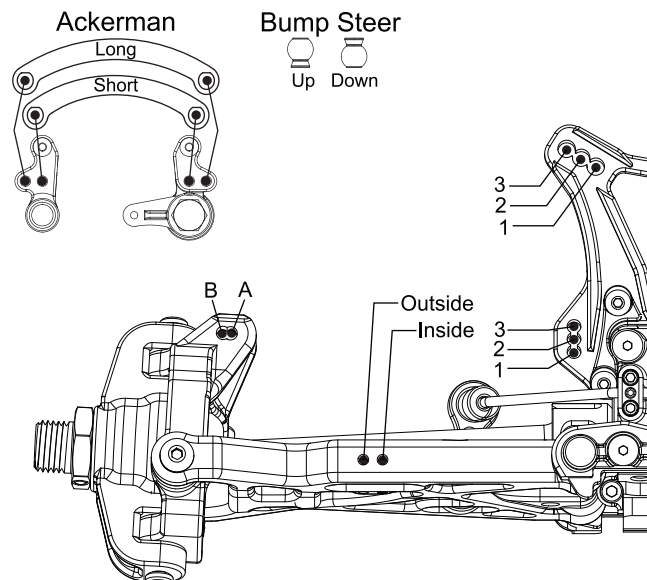

Notes: Adjustable pivots with 0 inserts.  
55 piston with all six holes drilled out with a #54 bit.  
3/4 rebound.

## Rear Suspension

Toe: 3 Degrees  
Anti-Squat: 3 Degrees  
Ride Height: 29mm  
Camber: -2 Degree  
Rear Hub Spacing: Hubs in back position.  
Sway Bar: 2.3mm  
Piston/Oil: 56/25wt Losi  
Spring: Green  
Limiter/Droop: \_\_\_\_\_  
Overall Shock Length: 106mm  
Camber Link: 2/B  
Shock Location: 2/Inside  
Rear Diff Fluid: 2000wt

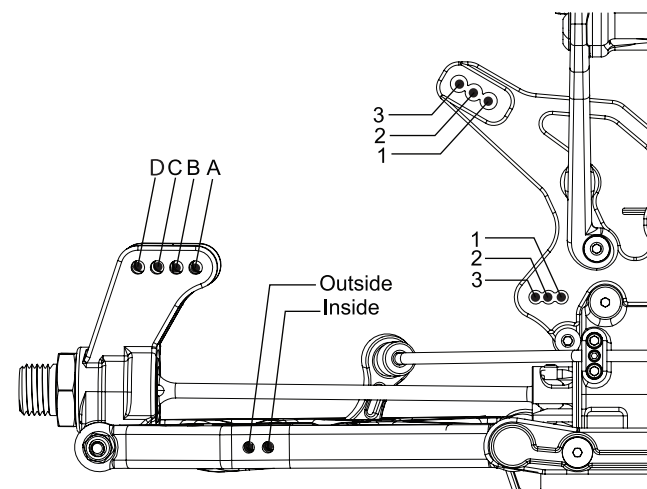

Notes: Adjustable pivots with 1's up in the front  
and 0's in the back. Alum. rear hubs.  
1/2 rebound.

## Engine

Engine: Nova Rossi Plus 4 Fuel: Nitrotane 30%  
Glow Plug: Nova Rossi 6 (C6TGC) Head Clearance: \_\_\_\_\_  
Pipe/Header: 9901 / 41021 Gearing: 13/48

## Clutch

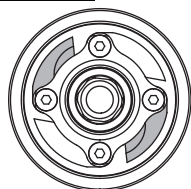

Clutch Shoes and Springs Info

2 Aluminum with Green Springs

2 Plastic with Black Springs

Steel Flywheel

## Tires

Type Compound Insert

Front: Losi Eclipse Silver Losi (Yellow)

Rear: Losi Eclipse Silver Losi (Yellow)

Notes: \_\_\_\_\_