

Name: <u>Standard Kit</u>	Date: _____
City: _____	Event: _____
State: _____	Track: _____

Track Conditions	<input type="checkbox"/> Indoor	<input type="checkbox"/> Tight	<input type="checkbox"/> Smooth	<input type="checkbox"/> Hard Packed	<input type="checkbox"/> Blue Groove	<input type="checkbox"/> Wet	<input type="checkbox"/> Low Bite	<input type="checkbox"/> High Bite
	<input type="checkbox"/> Outdoor	<input type="checkbox"/> Open	<input type="checkbox"/> Rough	<input type="checkbox"/> Loose/Loamy	<input type="checkbox"/> Dry	<input type="checkbox"/> Dusty	<input type="checkbox"/> Med Bite	<input type="checkbox"/> Other _____

Front Suspension

Toe: 1° Out

Ride Height: 27mm

Camber: -1°

Caster: 20°

Sway Bar: 2.32mm

Piston/Oil: 55/35wt. Team Losi

Spring: 4.4 Silver

Limiters/Droop: _____

Overall Shock Length: 4.100"

Steering Ackerman: Long

Bump Steer: Down

Camber Link: #2

Shock Location: #2/Inside

Front Diff Fluid: 5000wt.

Receiver Battery Type: 1400 mah

Center Diff Fluid: 7000wt.

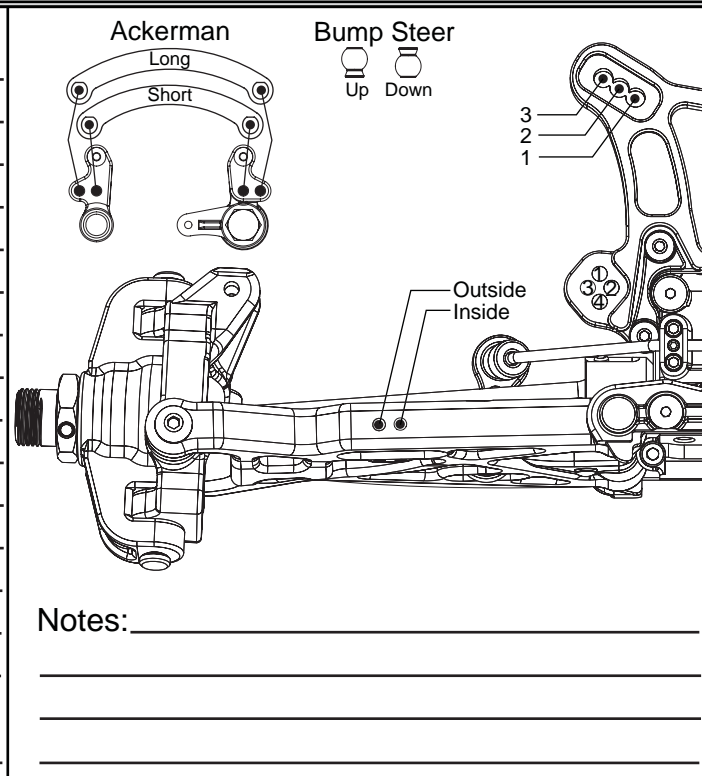

Rear Suspension

Toe: 3°

Anti-Squat: 2°

Ride Height: 29mm

Camber: -2°

Rear Hub Spacing: Back

Sway Bar: 2.68mm

Piston/Oil: 55/35wt. Team Losi

Spring: 3.1 Green

Limiters/Droop: _____

Overall Shock Length: 4.630"

Camber Link: 4-B

Shock Location: #2/Inside

Rear Diff Fluid: 2000wt.

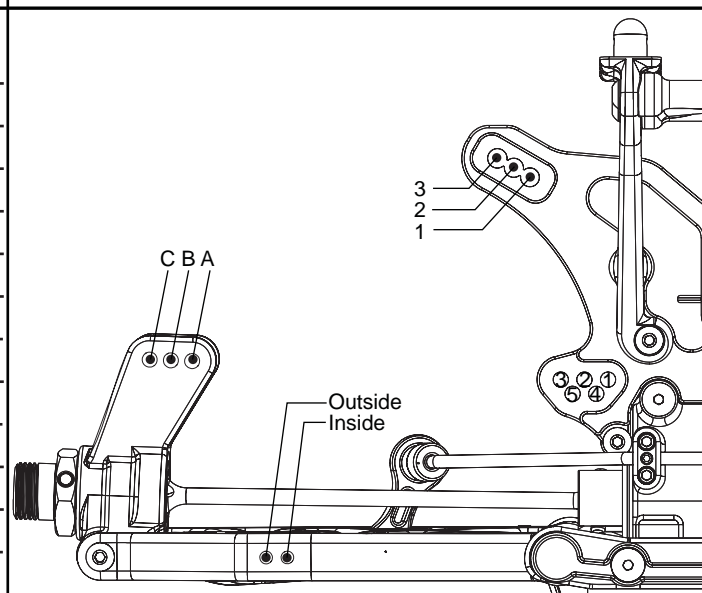

Engine

Engine: _____ Fuel: Team Losi Nitrotane

Glow Plug: _____ Head Clearance: _____

Pipe/Header: _____ Gearing: _____

Clutch

Clutch Shoes and Springs Info

2 Alum. with .040"/30° Silver Springs

2 Black with .040"/25° Gold Springs

Tires

	Type	Compound	Insert
Front:	<u>Step Pins</u>	<u>Silver</u>	<u>Stock Losi</u>
Rear:	<u>Step Pins</u>	<u>Silver</u>	<u>Stock Losi</u>
Notes:	_____		