

Name: Mike Truhe

Date: 2.24.07

Event: Dirt Nitro Challenge

City: _____ State: _____

Track: Nitro Pit

Track ☐ Indoor ☐ Tight ☐ Smooth ☒ Hard Packed ☐ Blue Groove ☐ Wet ☐ Low Bite ☐ High Bite
Conditions ☒ Outdoor ☒ Open ☒ Rough ☐ Loose/Loamy ☒ Dry ☒ Dusty ☒ Med Bite ☐ Other _____

Front Suspension

Toe: 2 degrees of toe-out

Ride Height: 27mm

Camber: -1 degree

Caster: stock (20 degrees)

Sway Bar: 2.3mm

Piston/Oil: 54 / 40wt Team Losi

Spring: Silver 4.4lbs

Limiter/Droop: 95mm

Overall Shock Length: _____

Steering Ackerman: Long

Bump Steer: Up

Camber Link: #2

Shock Location: #2 / inside

Front Diff Fluid: 5000 Team Losi

Receiver Battery Type: Dynamite 1400mah

Center Diff Fluid: 7000 Team Losi

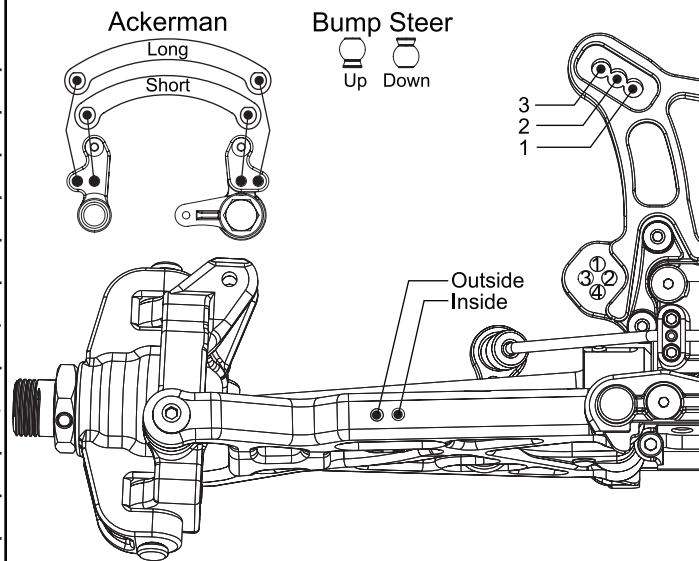

Notes: _____

Rear Suspension

Toe: 3 degrees

Anti-Squat: 3 degrees

Ride Height: 28mm

Camber: -2 degrees

Rear Hub Spacing: All the way back

Sway Bar: 2.3mm

Piston/Oil: 56 / 25wt Team Losi

Spring: Green 3.1lbs

Limiter/Droop: 106.5mm

Overall Shock Length: _____

Camber Link: #4 / A

Shock Location: #2 / inside

Rear Diff Fluid: 2000 Team Losi

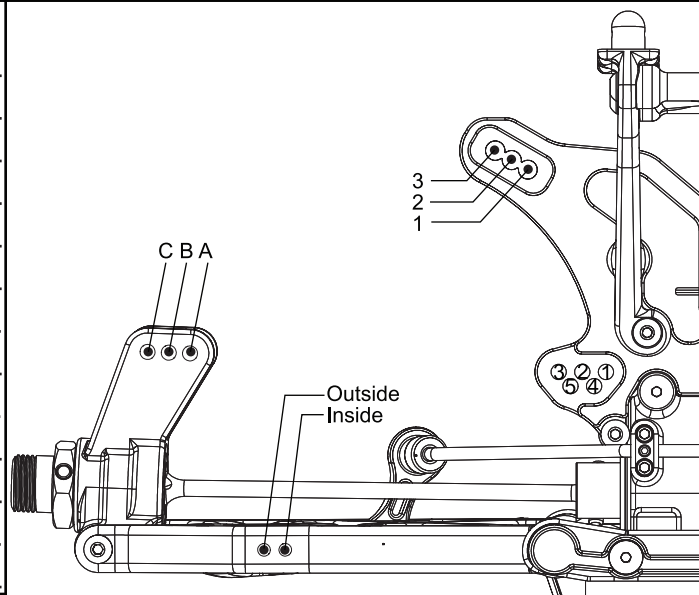

Notes: _____

Engine

Engine: Novarossi .21 Fuel: Nitrotane 30%

Glow Plug: Novarossi 6 Head Clearance: _____

Pipe/Header: Novarossi 9901 Gearing: 13 / 48

Clutch

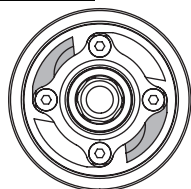

Clutch Shoes and Springs Info

2 Aluminum-Gold Springs

2 Plastic-Silver Springs

Tires

Type	Compound	Insert
Front: <u>TL Step Pin</u>	<u>Red</u>	<u>Stock</u>
Rear: <u>TL Step Pin</u>	<u>Red</u>	<u>Stock</u>

Notes: _____

