

Name: Adam Drake

Date: 2008

Event: Thunder Alley

City:

State:

Track:

Track ☐ Indoor ☐ Tight ☐ Smooth ☒ Hard Packed ☐ Blue Groove ☐ Wet ☐ Low Bite ☐ High Bite
Conditions ☒ Outdoor ☒ Open ☒ Rough ☐ Loose/Loamy ☒ Dry ☐ Dusty ☒ Med Bite ☐ Other _____

Front Suspension

Toe: 2 Degree Toe Out

Ride Height: 27mm

Camber: -2 Degrees

Caster: Stock

Sway Bar: 2.3mm

Piston/Oil: 55 / 35wt Losi

Spring: Silver

Limiter/Droop: 95mm

Overall Shock Length: _____

Steering Ackerman: Long

Bump Steer: Down

Camber Link: 2/A

Shock Location: 2/Inside

Receiver Battery Type: Losi

Differentials

Front: ☒ Standard ☐ Smart

Spring Wire Dia: n/a

Qty of Springs: n/a

Ramp Plate: n/a

Grease: n/a

Diff Fluid: 5000wt

Center: ☒ Standard ☐ Smart

Spring Wire Dia: n/a

Qty of Springs: n/a

Ramp Plate: n/a

Grease: n/a

Diff Fluid: 5000wt

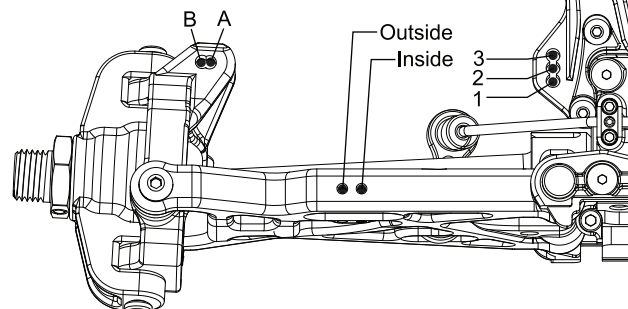
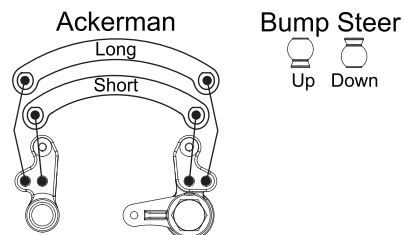

Notes: Adjustable pivots with 1's up in the front and 0's in the back.

Rear Suspension

Toe: 3 Degrees

Anti-Squat: 2 Degrees

Ride Height: 29mm

Camber: -1 Degree

Rear Hub Spacing: Hubs in back position.

Sway Bar: 2.3mm

Piston/Oil: 555666/25wt Losi

Spring: Silver

Limiter/Droop: 110mm from center to center.

Overall Shock Length: _____

Camber Link: 1/A

Shock Location: 3 / outside

Rear Diff Fluid: 3000wt

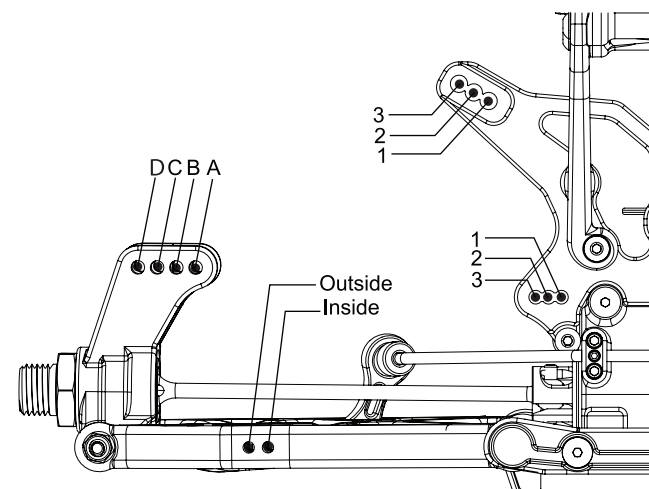

Notes: Adjustable pivots with 1's up in the front and 0's in the back.

56 pistons with three holes drill out with a #55 drill bit. 1mm wider hexes.

Engine

Engine: GRP .21 Mario Rossi Tuned Fuel: Nitrotane 30%

Glow Plug: GRP C5

Head Clearance: _____

Pipe/Header: GRP 2053

Gearing: 13/48

Clutch

Clutch Shoes and Springs Info

2 Aluminum with Gold Springs

2 Plastic with Green Springs

Steel Flywheel

Tires

Type

Compound

Insert

Front: Losi XBT Red Losi Yellow

Rear: Losi Eclipse Red Losi Yellow

Notes: _____

